

Procter & Gamble

Temselaan 100,
1853 Strombeek-Bever
Belgium

(in the north of Brussels)

Visitors entry on street Boechoutlaan

Phone reception +32 (0)2 / 456 46 06

komende van venant de coming from Sie kommen aus } Antwerpen A12

richting direction richting } Ring 0 - Gent
Strombeek-Bever

**AFRIT - SORTIE
EXIT - AUSFAHRT
7 BIS**

komende van venant de coming from Sie kommen aus } Gent E40

richting direction richting } Ring 0 - Luik
Strombeek-Bever

komende van venant de coming from Sie kommen aus } Zaventem
Antwerpen E19
Liège-Leuven E40

richting direction richting } Ring 0 - Gent
Strombeek-Bever

Visitors Entrance

Note: the visitors entry is on the street Boechoutlaan

**AFRIT - SORTIE
EXIT - AUSFAHRT
7 BIS**
STROMBEEK-BEVER

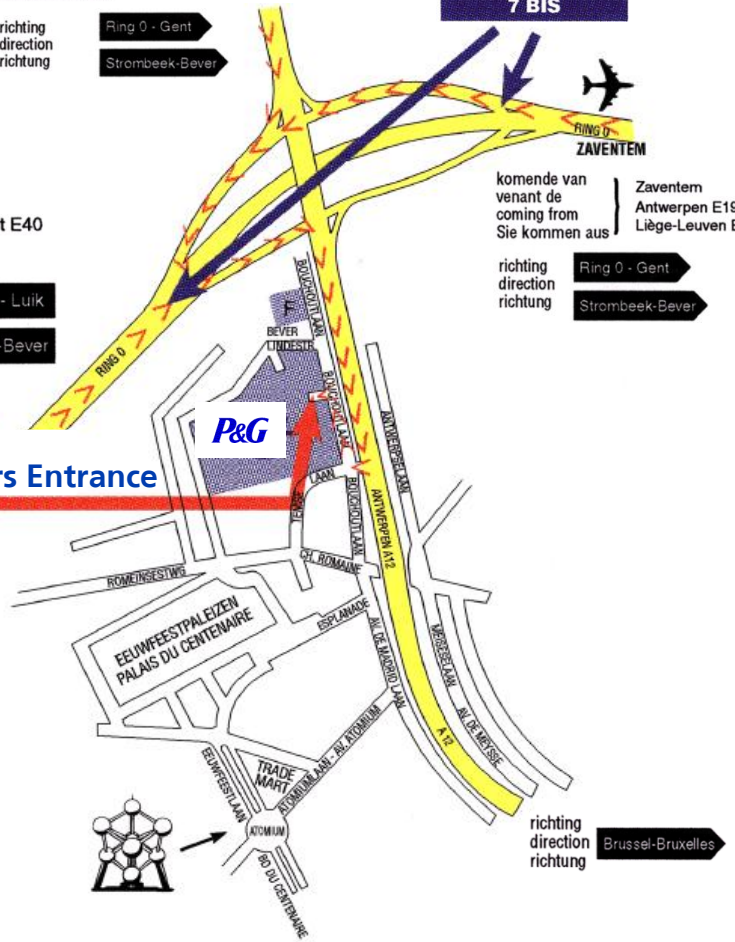
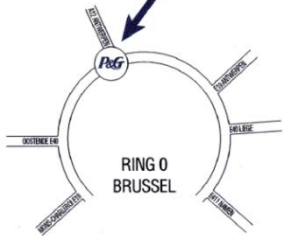

Coming from Gent (E40) or Mons - Charleroi (E19) :

follow the Ring-Road RO, direction "Antwerpen". Take exit 7 bis and follow the road signs to "Strombeek - Bever".

Coming from Antwerpen - Mechelen (E19) or Liège - Leuven - Zaventem (E40) :

follow the Ring-Road RO, direction "Gent". Take exit 7 bis and follow the road signs to "Strombeek - Bever".

How to reach P&G by public transport:

1. From train station Noordstation/Gare du Nord: take bus 251 (Brussel-Steenhuffel-Londerzeel-Puurs) until you reach bus-stop Madelon (+/- 30 minutes). You then arrive at the Romeinse Steenweg/Chaussée Romaine. Cross the street and take the first side-street (= a very small street called Temselaan).

From train station Noordstation/Gare du Nord: take tram 52 to Esplanade - Drogenbos (Station Laken Esplanade). When leaving this station, you will need to take the bridge to cross the A12. Go downstairs at the end of the bridge: you are now in the Avenue de Madridlaan. Cross the Romeinse Steenweg/Chaussée Romaine at the traffic lights. You are now in the Boechoutlaan and will see P&G on your left hand side (take the second street at your left).

2. From train station Centraal station/Gare Centrale: take the metro to Heysel (line 1A direction Koning Boudewijn/ Roi Baudouin) (+/- 25 minutes). When leaving the Heysel metro station, you will see different palaces of the Heysel in front of you. Turn right and walk straight on (the trade center is on your right as well). When you arrive at the end of the Esplanadesstraat, take left. Cross the Romeinse Steenweg/Chaussée Romaine at the traffic lights. You are now in the Boechoutlaan, P&G is on your left hand side (take the second street at your left).

Another possibility is to take the Minibus shuttle that stops at the Heysel metro station. It will take you to P&G!

From Heysel to P&G: at 7.15 am, 7.35 am, 7.55 am, 8.15 am, 8.35 am, 8.55 am and 9.15 am.

From P&G to Heysel: at 4.00 pm, 4.20 pm, 4.40 pm, 5.00 pm, 5.20 pm, 5.40 pm, 6.00 pm.

3. From train station Mechelen station/station of Mechelen: take the bus 280 (Mechelen-Verbrande Brug) until you reach bus-stop Vilvoorde station (+/- 30 minutes). When you arrive at bus-stop Vilvoorde station you will have to take bus 820 (Zaventem-Jette) until you reach bus-stop Madelon (+/- 30 minutes). You then arrive at the Romeinse Steenweg/Chaussée Romaine. Cross the street and take the first side-street (= a very small street called Temselaan).

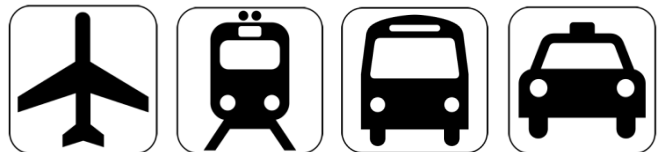

4. From Brussels Airport at Zaventem: take bus 820 (Zaventem-Jette) until you reach bus-stop Madelon (+/- 30 minutes). You then arrive at the Romeinse Steenweg/Chaussée Romaine. Cross the street and take the first side-street (= a very small street called Temselaan).

5. From train station Vilvoorde station: take bus 820 (Zaventem-Jette) until you reach bus-stop Madelon (+/- 30 minutes). You then arrive at the Romeinse Steenweg/Chaussée Romaine. Cross the street and take the first side-street (= a very small street called Temselaan).

6. From train station Gent Sint-Pieters: take the train De Panne - Landen or Blankenberge - Tongeren (+/- 40 minutes) until you reach Brussel Noordstation/Gare du Nord. There you take bus 250 (Brussel-Londerzeel-Liezele-Puurs) until you reach bus-stop Madelon (+/- 30 minutes). You then arrive at the Romeinse Steenweg/Chaussée Romaine. Cross the street and take the first side-street (= a very small street called Temselaan).

How to get there



**Metro
Bus**

**HEYSEL
HEIZEL**

Info
stib.be
mivb.be
070 23 2000

